

smartwares® SL1-DOB10

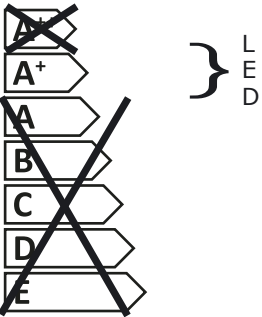

This luminaire contains built-in LED lamps.



The lamps cannot be changed in the luminaire

874/2012



smartwares® SL1-DOB10



Diese Leuchte enthält eingebaute LED-Lampen.

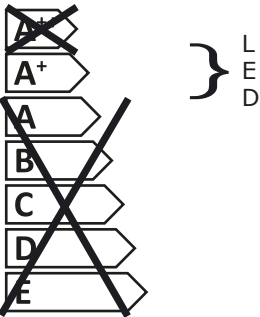

Die Lampen können in der Leuchte nicht ausgetauscht werden.

874/2012



smartwares® SL1-DOB10



Ce luminaire est composé des lampes à LED intégrées.

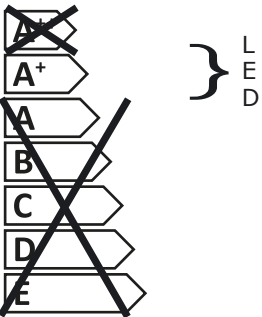

Les lampes de ce luminaire ne peuvent pas être changées.

874/2012



smartwares® SL1-DOB10



Deze armatuur bevat ingebouwde LED-Lampen.

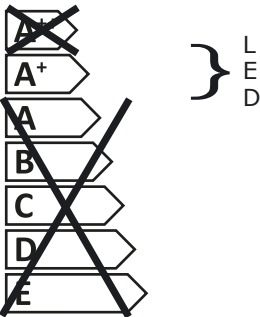

In de armatuur kunnen de lampen niet worden vervangen.

874/2012



220-240V~50HZ
10W

IP44



CUSTOMER SERVICE	
NL: 088 5940501	Lokaal tarief
BE: 078 481094(NL)	Lokaal tarief
BE: 078 481540(FR)	Tarif local
FR: 0825 560 650	18ct/min
DE: +49 (0) 1805 010762	
	1+CT/Min. dt. Festnetz,
	Mobil max. 42CT/Min
UK: +44 (0) 345 230 1231	
ES: +34 938427389	
smartwares® Europe	
Jules Verneweg 87	
5015 BH Tilburg	
The Netherlands	
service.smartwares.eu	



smartwares®



QUICK & EASY INSTALL

LED security light

NL LED beveiligingslamp DE LED-Sicherheitsleuchte FR éclairage de sécurité à led
ES Luz de seguridad LED IT lampada di sicurezza a led PT Luz de segurança LED
SV LED-säkerhetsbelysning TR LED güvenli lambası PL światło alarmowe led



INDOOR AND
OUTDOOR

10
WATT

800
LUMEN



QUICK
INSTALLATION



MOTION
SENSOR

SL1-DOB10 - 10.046.94

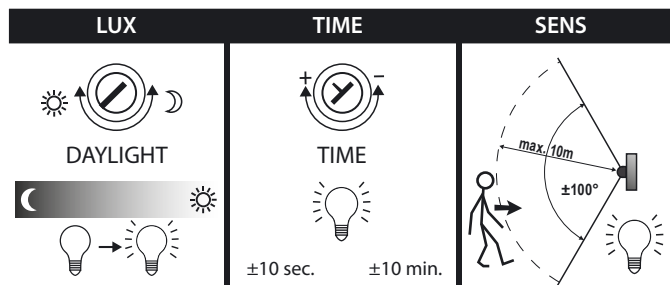
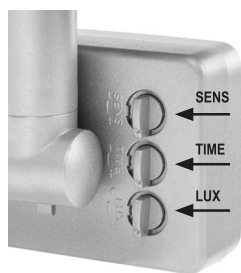
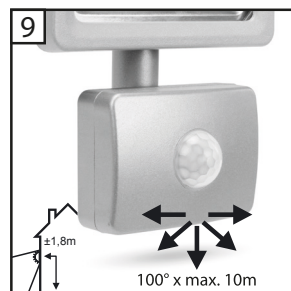
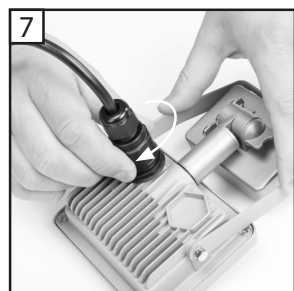
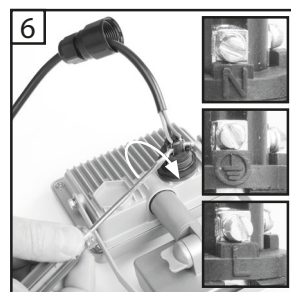
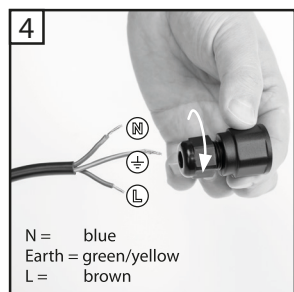
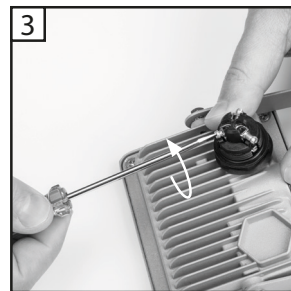
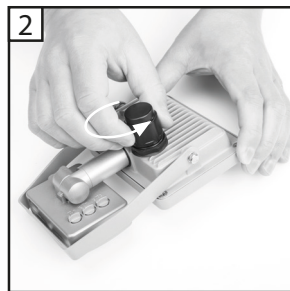
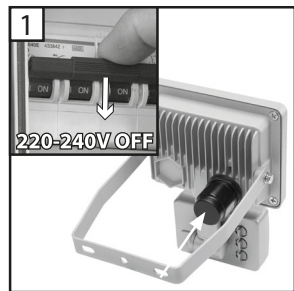

10 WATT LED	800 lm	10M x 100°	
-SENS+	-TIME+	-LUX+	
4 M - 10 M	10 SEC. - 10 MIN.	LIGHT TO DARK	
	0s	NATURAL WHITE ±4000K	1,0m
ON OFF 15.000 X	±1.8m	25.000 h	220-240V~ 50HZ
100° BEAM ANGLE	IP44	RA>65	380 gr.



- GB** The fixture is splash-proof.
- NL** Het armatuur is spatwaterdicht.
- F** L'armature est étanche aux projections d'eau.
- D** Die Armatur ist spritzwasserdicht.
- N** Armaturet er beskyttet mot sprut.
- S** Armaturen är tät mot stänkvatten.
- DA** Armaturet er stænkæt.
- FIN** Valaisin on roiskevedenpitävä.
- PL** Urządzenie jest bryzgoszczelne.
- RUS** Осветительная арматура является брызгозащитенной.
- BG** Осветителното тяло е устойчиво на намокряне.
- H** A szerelvény fröccsenésálló.
- RO** Corpul de iluminat este rezistent la stropire.
- SK** Zariadenie je chránené proti postriekaniu.
- HR** Svjetiljka je zaštićena protiv štrcanja vode.
- CZ** Zařízení je chráněno proti postřiku.
- SLO** Nosilec je odporen proti curkom.
- I** La lampada è protetta contro gli spruzzi d'acqua.
- P** A ferragem de conexão é a prova de salpicos.
- E** El montaje está protegido contra salpicaduras.
- GR** Η εφαρμογή είναι αδιάβροχη στα πισσιλίσματα.
- TR** Tertibat sýçramalara karpý dayanýklýdýr.

- GB** Protection class 1: the fitting must be earthed.
- NL** Beschermklasse 1, het armatuur moet geaard worden.
- F** Classe de sécurité 1, l'armature doit être mise à la terre.
- D** Schutzklasse 1, die Armatur muss geerdet werden.
- N** Beskyttelsesklasse 1: armaturet må jordes.
- S** Skyddsklass 1, armaturen måste jordas.
- DK** Beskyttelsesklasse 1, armaturet skal have jordforbindelse.
- FIN** Suojausluokka 1, valaisin pitää maadoittaa.
- PL** Klasa zabezpieczenia 1: urządzenie musi być uziemione.
- RUS** Класс защиты 1: арматура должна быть заземлена.
- BG** Защита от клас 1: осветителното тяло трябва да е заземено.
- H** 1. védelmi osztály: a szerelvény földelhető.
- RO** Clasă 1 de protecție: corpul de iluminat trebuie împământat.
- SK** Trieda ochrany 1: zariadenie musí byť uzemnené.
- HR** Klasa zaštite 1: svjetiljka mora biti uzemljena.
- CZ** Třída ochrany 1: zařízení musí být uzemněno.
- SLO** Zaščitni razred 1: nosilec senzorja je potrebno ozemljiti.
- I** Classe di protezione 1, la lampada deve avere la messa a terra.
- P** Classe 1 de protecção: a ferragem de conexão deve ser ligada à terra.
- E** Protección de Clase 1: el montaje debe estar conectado a tierra.
- GR** Προστατευτικό γυαλί 1: η εφαρμογή πρέπει να γειωθεί.
- TR** Emniyet türü 1: Tertibat topraklanmalıdır.