

smartwares® ES94

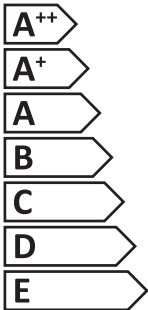

This luminaire is compatible with bulbs of the energy classes:



874/2012



smartwares® ES94



Diese leuchte ist für Leuchtmittel der Energieklassen geeignet:

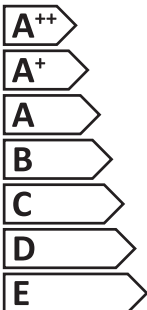

874/2012



smartwares® ES94



In deze armatuur passen lampen van energieklassen:

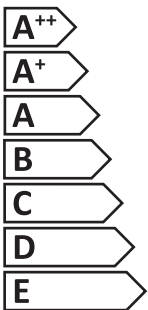

874/2012



smartwares® ES94



Ce luminaire est compatible avec les ampoules des classes énergétiques:

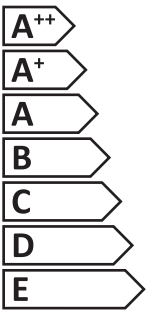

874/2012



IP44

CUSTOMER SERVICE	
NL: 088 5940501	Lokaal tarief
BE: 078 481 094(NL)	Lokaal tarief
BE: 078 481 540(FR)	Tarif local
FR: 0825 560 650	18ct/min
DE: +49 (0) 1805 010762	14ct/Min. dt. Festnetz
	Max. 43ct/Min. Mobil max. 43ct/Min.
UK: +44 (0) 345 730 1231	
ES: +34 938427589	
smartwares® Europe	
Jules Verneweg 87	
5015 BH Tilburg	
The Netherlands	
service.smartwares.eu	

10.021.30-20141.216;GAL.4A



smartwares®



INDOOR AND OUTDOOR



MOTION DETECTION

100

WATT MAX.



±110° MAX. 14M

## outdoor light with motion detector

- GB** Romantic carriage lamp with motion detector
- DE** Außenleuchte Antikes Design mit Bewegungsmelder
- PL** Oświetlenie zewnętrzne z detektorem ruchu Romantyczna lampa powozowa
- NL** Romantische buiten koetslamp met bewegingsmelder
- FR** Lanterne de style classique extérieur avec détecteur de mouvements
- ES** Lámpara clásica exterior con detector de movimiento

ES94 / 10.021.30

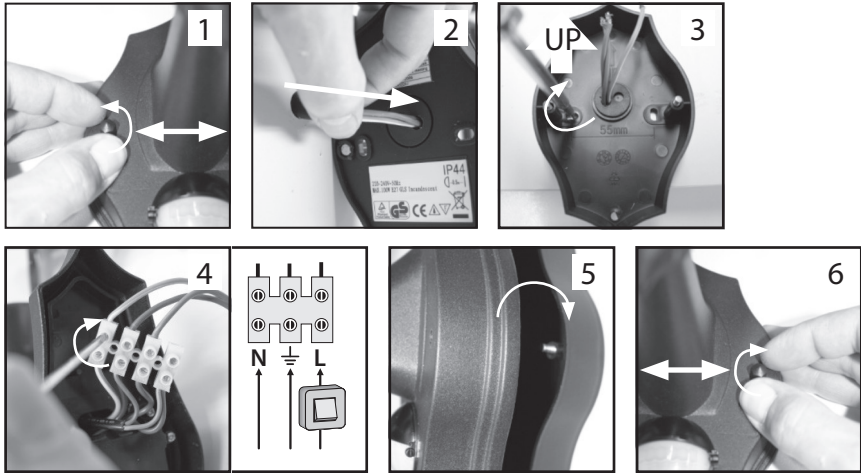

ES94 / 10.021.30	
POWER	220-240V~ 50Hz
WATTAGE	23W CFL or 100W incandescent lamp
PROTECTION CLASS	IP44
DIMMABLE	NO
ISOLATION CLASS	I

